



NATURAL AND UNIQUE

DURABLE CHARRED WOOD



ABOUT US

Our team has been learning from experts in their field for a long time. And just to **improve** existing **woodwork processes, speed up workflows**, and most importantly, **improve product quality**.

The client (more precisely *You*) — is the person to whom we will give our full attention, **from order preparation before the goods are delivered to your home**. We continue to assist you after the installation process, providing help and expertise on how to take care of the wood, ensuring its longevity and beauty over time.

OUR PRIORITIES

- 01.** Fulfill customer needs by providing exceptional standards in communication and product quality.
- 02.** Loyalty to our customers and attention to even the smallest details help us grow and improve.
- 03.** Continuous improvement of work performance and system optimization streamline our work processes, enabling smoother achievement of corporate goals.



WHY CHOOSE CHARRED TIMBER?



Durability: Naturally resistant to rot, pests, and weathering.



Eco-Friendly: Sustainable and free from chemical treatments.



Distinctive Aesthetics: A unique charred texture that complements modern and Traditional designs.



Low Maintenance: Minimal upkeep required over time.



Versatility: Perfect for cladding, decking, fencing, and interiors.

OUR PROCESS

01



WOOD SELECTION

The process begins with selecting durable timbers like oak, spruce, larch, or accoya for their strength and charring suitability.

02



CHARRING THE WOOD

Then, the wood is flame-charred to form a protective layer with controlled char depth for the ideal texture and look.

03



BRUSHING PROCESS

The wood is brushed to reveal the grain beneath the charred surface, enhancing its texture and ensuring long-lasting quality.

04

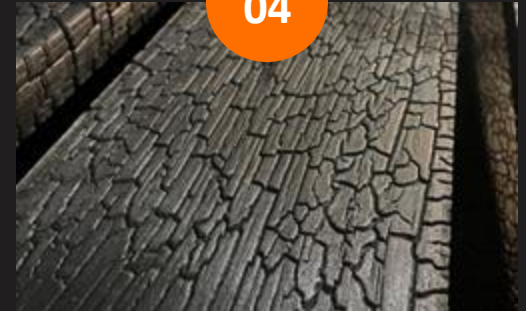

OILING & FINISHING

After brushing, a protective coating is applied. It enhances natural wood color, provides durability, and protects the wood against external

elements.

OUR PRODUCTS



CLADDING

We provide durable burnt wood facade products in various profiles, treated with the century-old Shou Sugi Ban technique for enhanced strength, longevity, and environmental resistance.



DECKING

Outdoor terraces face significant environmental impacts. By choosing our Shou Sugi Ban technology products, you are assured that your terrace will be much more durable than any other timber product in the market.



FENCING

Fences provide privacy and should look perfect. We offer high-quality, modern wood protection and customizable colors for exceptional wooden fences.

OUR COLOURS | LARCH



White



Stone Grey



Thunder Grey



Anthracite

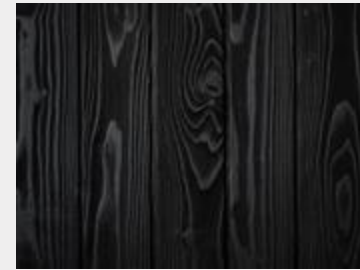

Black

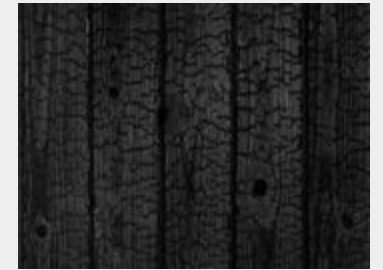

Carbon



Natural



Teak



Hazelnut



Clay Grey



MossGreen



Mahogany

OUR COLOURS | SPRUCE



White



Grey



Stone Grey



Thunder Grey



Anthracite



Black

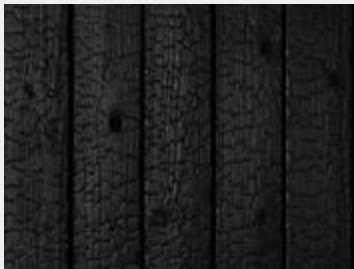

Carbon



Natural



Teak



Chestnut



Hazelnut



Walnut



Clay Grey



MossGreen



Mahogany

OUR COLOURS | OAK



Thunder Grey



Anthracite



Black



Carbon



Teak



Hazelnut

OUR COLOURS | ACCOYA



Grey



Black



Carbon



Teak



Hazelnut

OUR CORNERS | LARCH



Height (mm)	Width (mm)	Length (mm)
45	45	3000; 4000

OUR PRODUCTS | SCREWS

We offer a wide range of high-quality stainless-steel screws for **cladding, decking, and fencing**, designed for durability and a secure hold.

Our stainless-steel screws provide excellent resistance to weather and corrosion, ensuring long-lasting performance.

For more, contact us!



OUR PRODUCTS | OIL

We offer a wide range of **high-quality of Italian oils** in various colors for your charred wood, designed to enhance and protect its unique texture.

Perfect for facade, terrace and fence, they help preserve the wood while enriching its character.

For more colors, contact us!



MAINTENANCE



How to Properly Clean Charred Wood Surfaces

To clean your charred wood cladding, decking, or fence, use plain water and a soft brush. If needed, use soapy water, preferably of the eco-friendly variety.



Re-oiling Charred Wood

Re-oiling should be tailored to the specific needs of each project. The south-facing side of a building may require more frequent re-oiling, approximately every 5 to 10 years.



<https://dragonwood.eu/en>

DRAGONWOOD

INSTALLATION GUIDE

INSTALLATION

Vertical Wall Cladding - Timber Frame Construction

- 01** Install the breathable sarking over the studs, ensuring all overlaps face downward and all joints are completely taped.
- 02** Ensure that all corner trims, end stops, and any necessary flashing beneath the cladding are properly installed.
- 03** Attach horizontal battens (e.g., 70×35 pine or top hat sections) at approximately 450mm intervals.
- 04** Ensure adequate drainage is provided for any moisture flowing down the sarking within the breathable cavity. This may involve measures such as notching the bottom plate or batten, setting the noggins back from the front face of the studs, and extending the sarking beneath the window header flashings to allow moisture to escape effectively.
- 05** Install the bottom angle, corner stops, and any required flashings as needed. Refer to the construction details for guidance.
- 06** Mark the board increments on the front face of the studs or mounting battens. This step ensures the expansion gap for the cladding is accounted for, prevents cumulative errors and misalignment, and guarantees that the run starts and ends with an appropriately sized board.
- 07** Install the cladding by pre-drilling and fastening through the tongue, angling the screw slightly if necessary. The groove of the subsequent board should conceal the screw in the previous board.

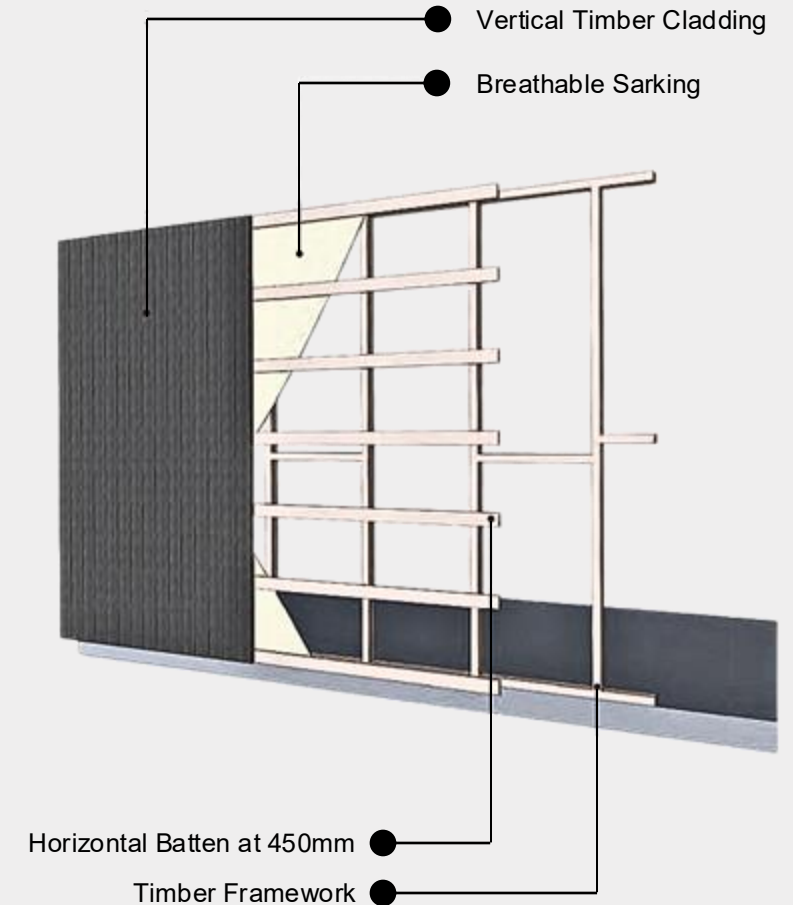

INSTALLATION

Vertical Cladding - Masonry Wall Construction

- 01** Attach horizontal battens (e.g., 70×35 mm H3-treated pine or top hat sections) to the masonry wall at approximately 450 mm intervals.
- 02** Ensure there is an adequate drainage solution for any moisture running down the wall within the breathable cavity. This can involve measures such as notching the bottom plate or battens and setting the noggins back from the front face of the stud to allow proper escape.
- 03** Install the bottom angle, corner stops, and any required flashings as needed. Refer to the construction details for guidance.
- 04** Mark the board increments on the front face of the studs or mounting battens. This step ensures the expansion gap in the cladding is accounted for, prevents cumulative errors and misalignment, and allows you to start and finish the run with an appropriate board width.
- 05** Install the cladding by pre-drilling and fastening through the tongue, angling the screw slightly if necessary. The groove of the next board should conceal the screw in the previous board.

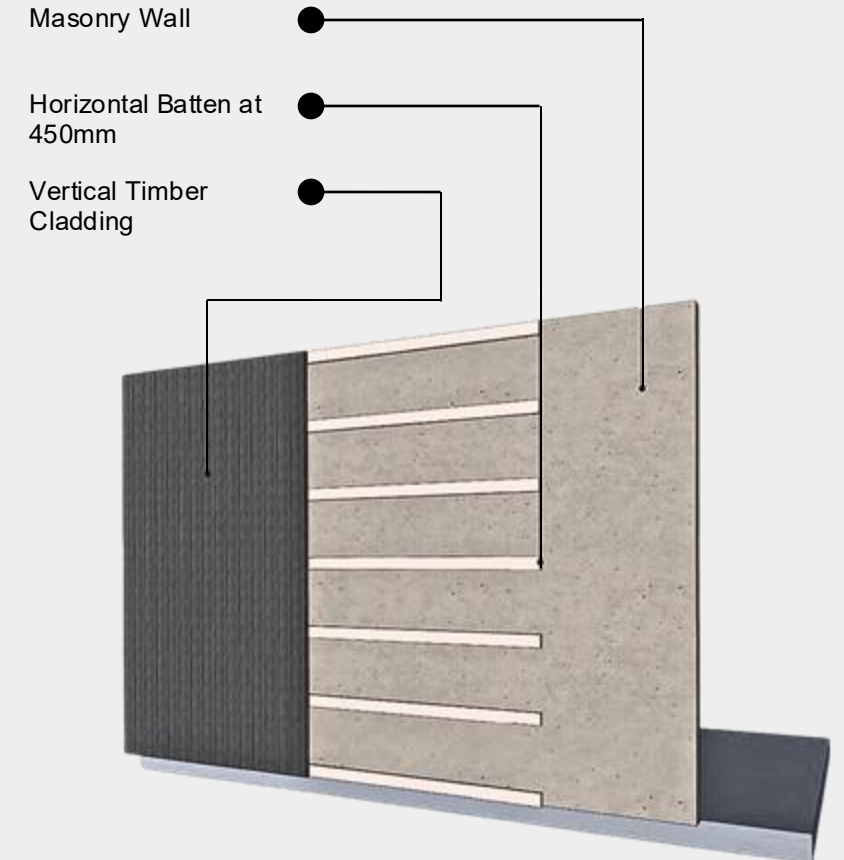

INSTALLATION

Horizontal Cladding - Timber Wall Construction

- 01** Install the breathable sarking over the studs, ensuring all overlaps are oriented downward and all joints are securely taped.
- 02** Attach vertical battens (e.g., 70×35 pine or top hat sections) at approximately 450mm centers.
- 03** Ensure adequate drainage is provided for any moisture running down the sarking within the breathable cavity. This may involve notching the bottom plate or batten, setting the noggins back from the front face of the studs, and extending the sarking beneath the window header flashings to facilitate moisture escape.
- 04** Install the bottom angle, corner stops, and any required flashings as needed. Refer to the construction details for specific instructions.
- 05** Mark the board increments on the front face of the studs or mounting battens. This step ensures the cladding expansion gap is accounted for, prevents cumulative errors and misalignment, and guarantees that the run begins and ends with an appropriate board width.
- 06** Install the cladding by pre-drilling and securing it through the tongue, with the screw inserted at a slight angle if needed. The groove of the next board should conceal the screw from the previous one.

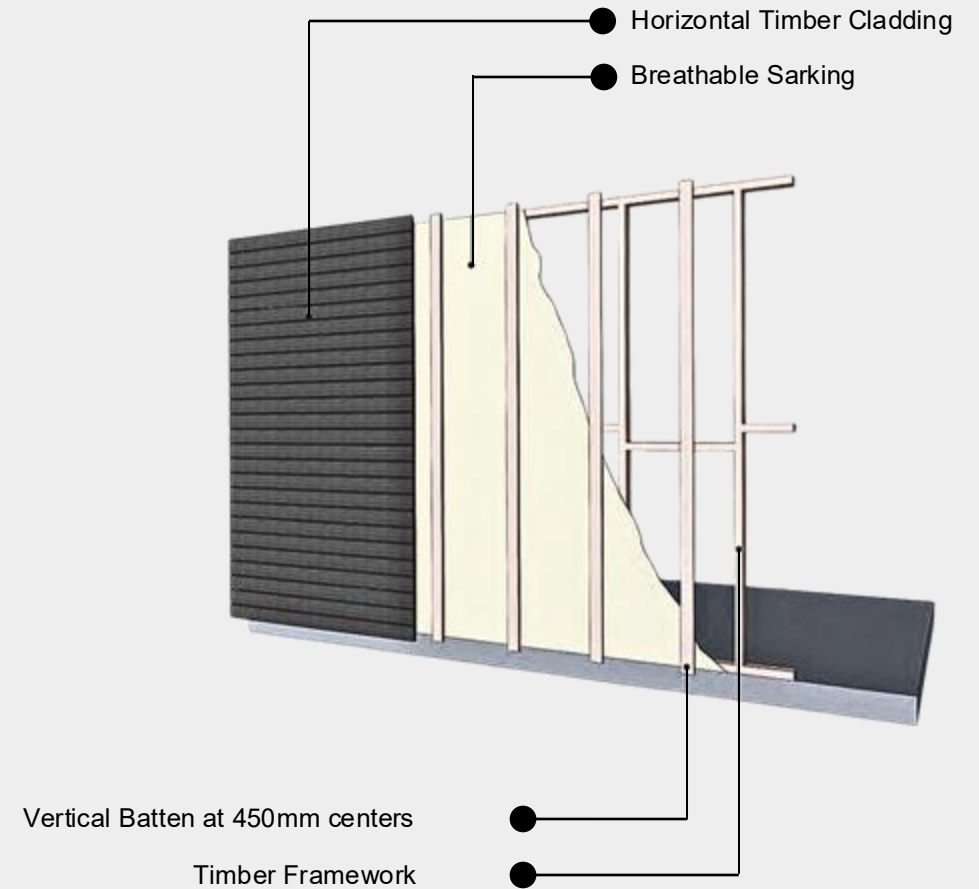

INSTALLATION

Horizontal Cladding - Masonry Wall Construction

- 01** Attach vertical battens (e.g., 70×35 H3 treated pine or top hat sections) to the masonry wall, spaced approximately 450mm apart.
- 02** Ensure proper drainage is provided for any moisture running down the wall within the breathable cavity. This may involve, but is not limited to, notching the bottom plate or battens and setting the noggins back from the front face of the studs to allow for moisture escape.
- 03** Install the bottom angle, corner stops, and any required flashings as needed. Refer to the construction details for guidance.
- 04** Mark the board increments on the front face of the studs or mounting battens. This ensures the cladding expansion gap is maintained, prevents cumulative errors and misalignment, and ensures the run begins and ends with the appropriate board width.
- 05** Install the cladding by pre-drilling and fastening through the tongue, with the screw possibly inserted at a slight angle. The groove of the next board should cover the screw from the previous board.

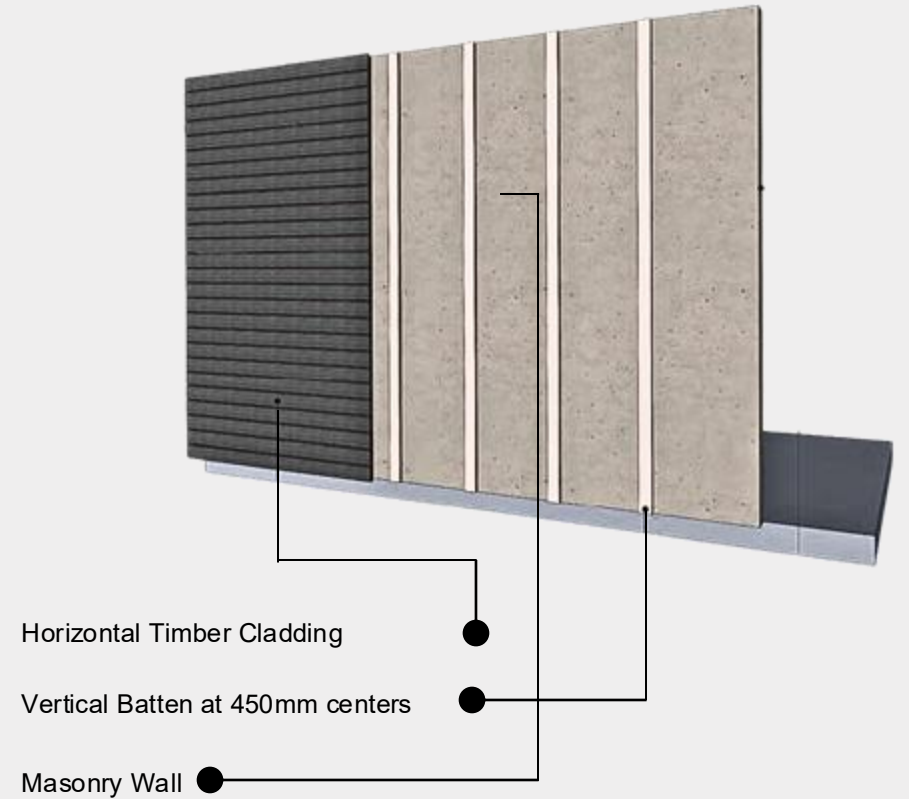

SCREWS | FIXING

The boards must be secured using face screws, taking care not to allow the screw heads to penetrate the charred surface, as this could compromise the appearance and durability of the finish. Each fixing point should be secured with two screws (approximately 40 screws per m²). The length of the screws required will depend on the depth of the battens or substructure being used, ensuring a secure and stable installation. Proper screwing technique is essential to maintain the integrity and aesthetic of the charred wood surface.

Screwing distance

Two screws every

500-600 mm

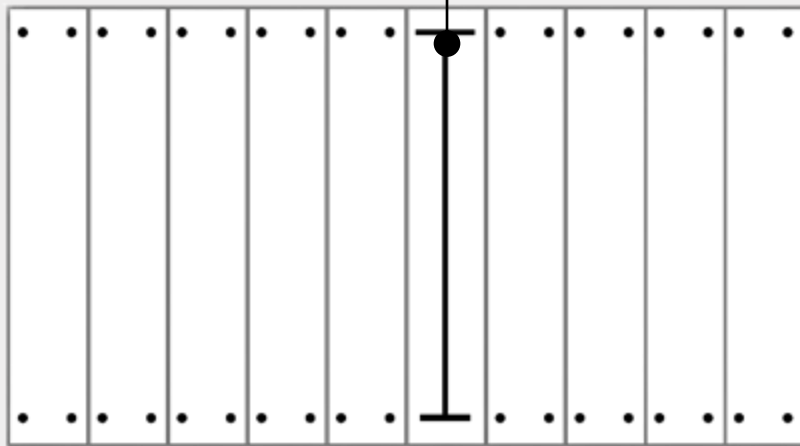

Recommended screws

Stainless steel screws only

Screws size

42 mm screw length for **18-20 mm** board.

Make sure screw head line is correct.

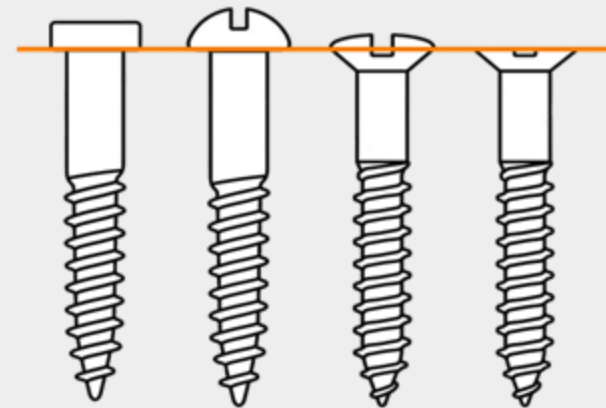



<https://dragonwood.eu/en>

DRAGONWOOD

PROFILES



Cladding

Shadow Gap

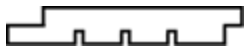

Height (mm)	Width (mm)	Face cover (mm)	Length (mm)	Gap (mm)
20	95	80	3000; 4000; 6000	5
20	120	105	3000; 4000; 6000	5
20	145	130	3000; 4000; 6000	5

Shadow Gap 45

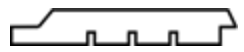

Height (mm)	Width (mm)	Face cover (mm)	Length (mm)	Gap (mm)
20	95	-	3000; 4000; 6000	5
20	120	-	3000; 4000; 6000	5
20	145	-	3000; 4000; 6000	5

T&G v Joint

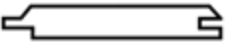

Height (mm)	Width (mm)	Face cover (mm)	Length (mm)	Gap (mm)
20	95	85	3000; 4000; 6000	N/A
20	120	110	3000; 4000; 6000	N/A
20	145	135	3000; 4000; 6000	N/A

T&G Shadow Gap

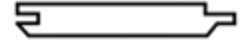

Height (mm)	Width (mm)	Face cover (mm)	Length (mm)	Gap (mm)
20	95	85	3000; 4000; 6000	5
20	120	110	3000; 4000; 6000	5
20	145	135	3000; 4000; 6000	5



Cladding

Double Shadow Gap



Height (mm)	Width (mm)	Face cover (mm)	Length (mm)	Gap (mm)
20	120	110	3000; 4000; 6000	10
20	145	135	3000; 4000; 6000	10

Triple Shadow Gap



Height (mm)	Width (mm)	Face cover (mm)	Length (mm)	Gap (mm)
20	120	110	3000; 4000; 6000	N/A
20	145	135	3000; 4000; 6000	5

Rainscreen



Height (mm)	Width (mm)	Face cover (mm)	Length (mm)	Gap (mm)
20	95	85	3000; 4000; 6000	N/A
20	120	110	3000; 4000; 6000	N/A
20	145	135	3000; 4000; 6000	N/A

PAR (square edge)



Height (mm)	Width (mm)	Face cover (mm)	Length (mm)	Gap (mm)
20	95	95	3000; 4000; 6000	N/A
20	120	120	3000; 4000; 6000	N/A
20	145	145	3000; 4000; 6000	N/A

NEW! Charred
Termo-treated pine

*All profiles are
available*

Height (mm)	Width (mm)	Face cover (mm)	Length (mm)	Gap (mm)
20	120	Depends on chosen profile	3000; 3300; 3900; 4500; 4800	Depends on chosen profile
20	145	Depends on chosen profile	3000; 3300; 3900; 4500; 4800	Depends on chosen profile



Decking & Corners

DECKING

PAR (square edge)



Height (mm)	Width (mm)	Length (mm)
28; 45	120; 145	3000; 4000; 6000

PAR (fluted)



Height (mm)	Width (mm)	Length (mm)
28; 45	120; 145	3000; 4000; 6000

CORNERS

Corner Batten



Timber	Height (mm)	Width (mm)	Length (mm)
Spruce	45	45	3000
Larch	45	45	4000

Corner



Timber	Height (mm)	Width (mm)	Length (mm)
Spruce	45	45	3000
Larch	45	45	4000



Cladding Profile Drawings

Shadow Gap

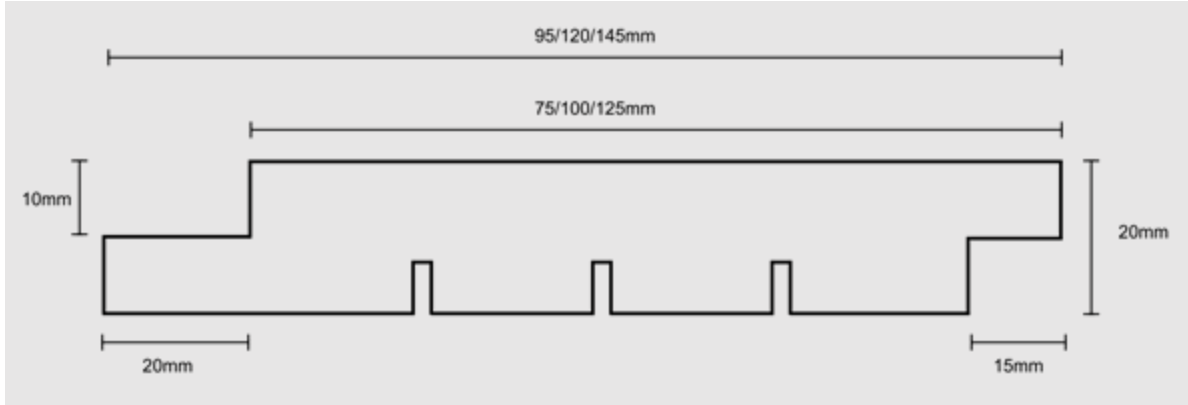

Shadow Gap 45

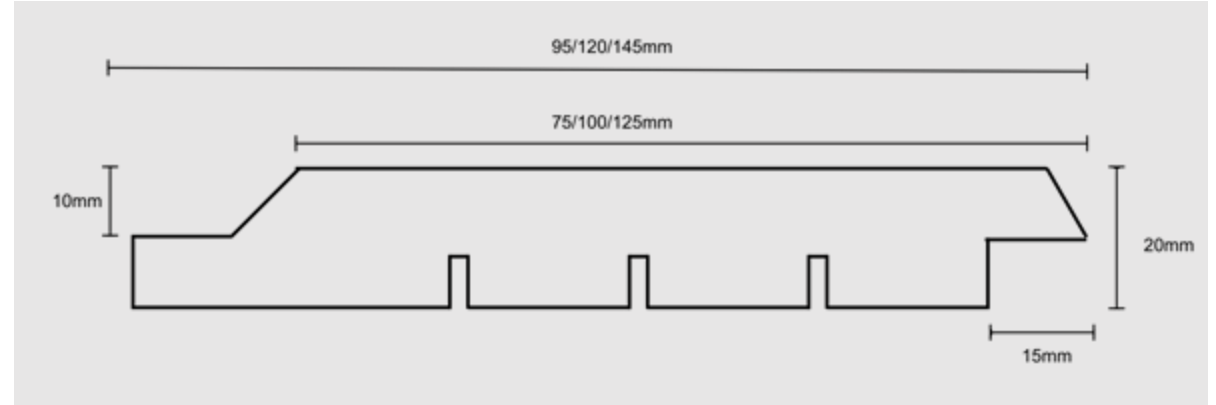

T&G v Joint

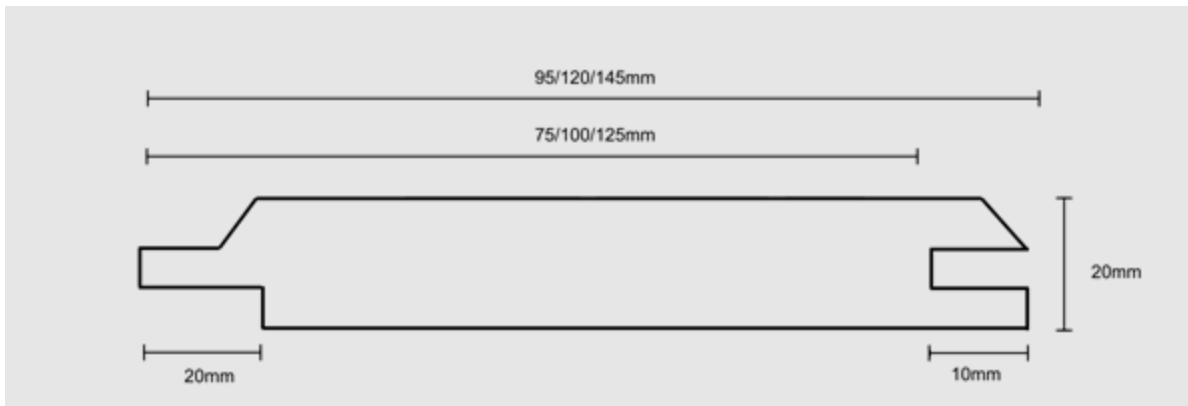

T&G Shadow Gap

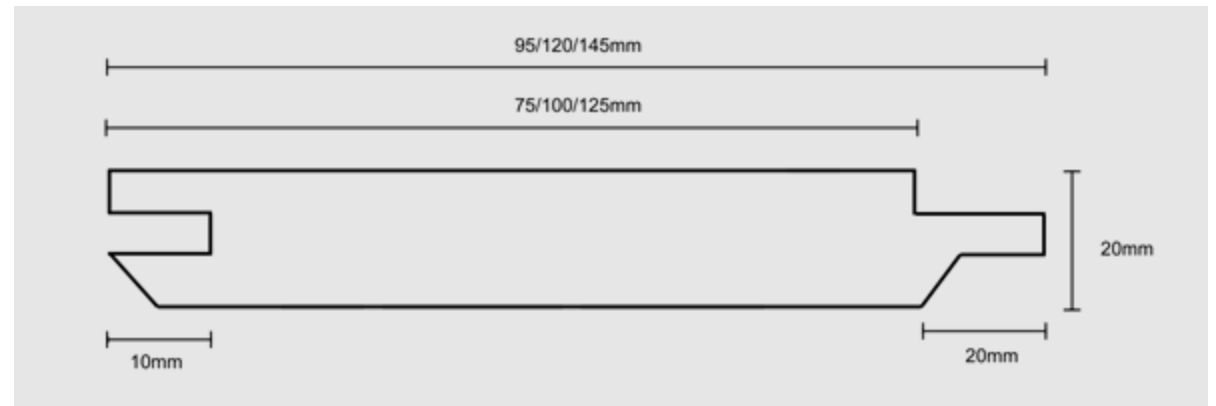



Cladding Profile Drawings

Double Shadow Gap

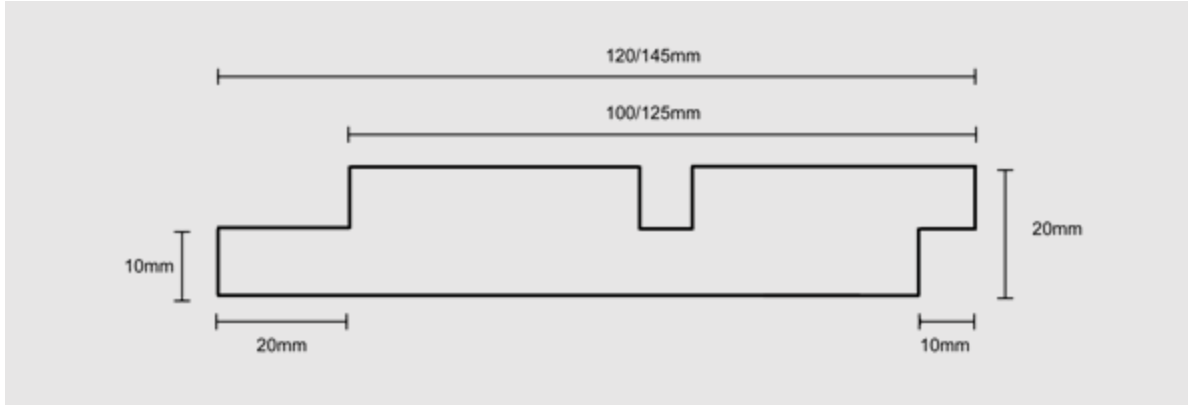

Triple Shadow Gap

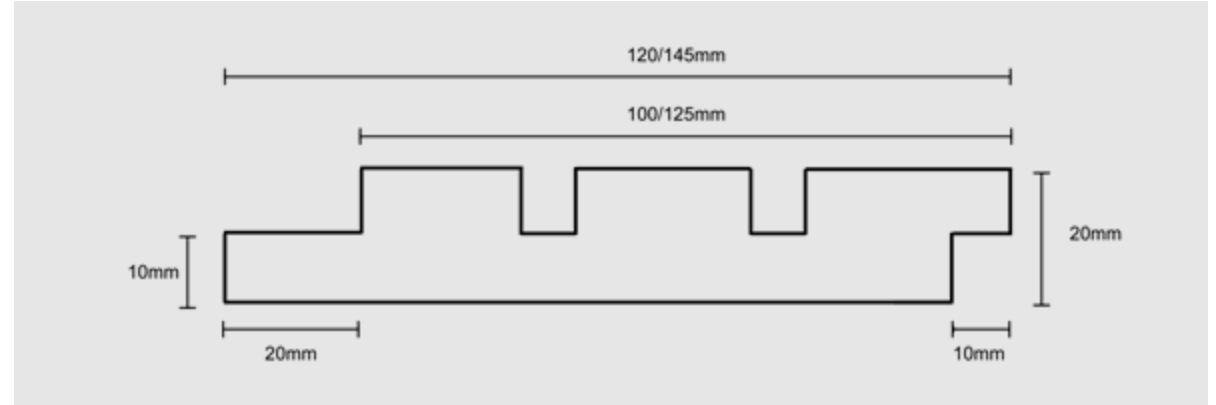

Rainscreen

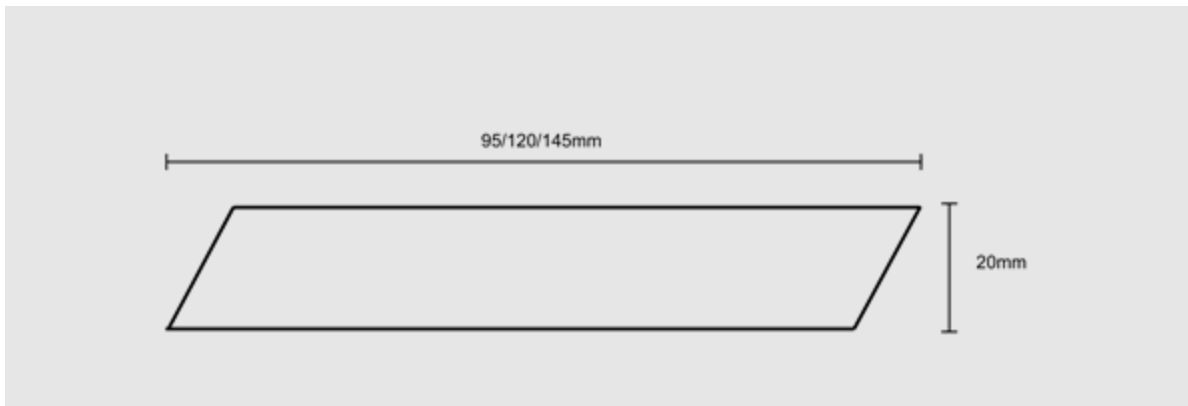

PAR (square edge)

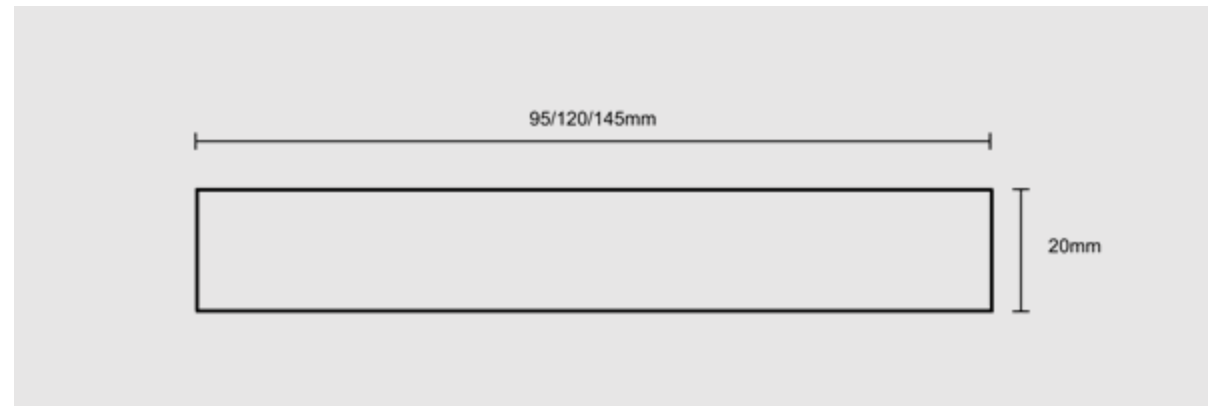



Decking Profile Drawings

PAR (square edge)

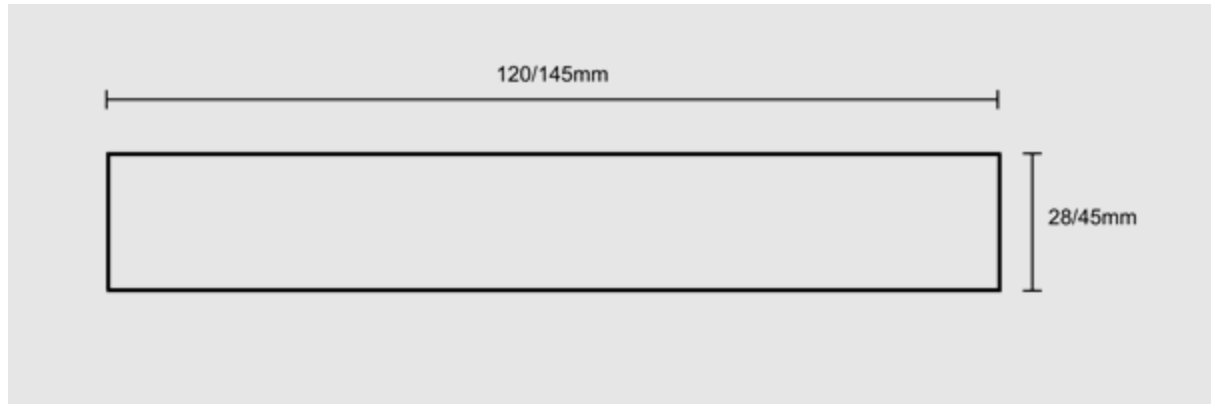

PAR (fluted)

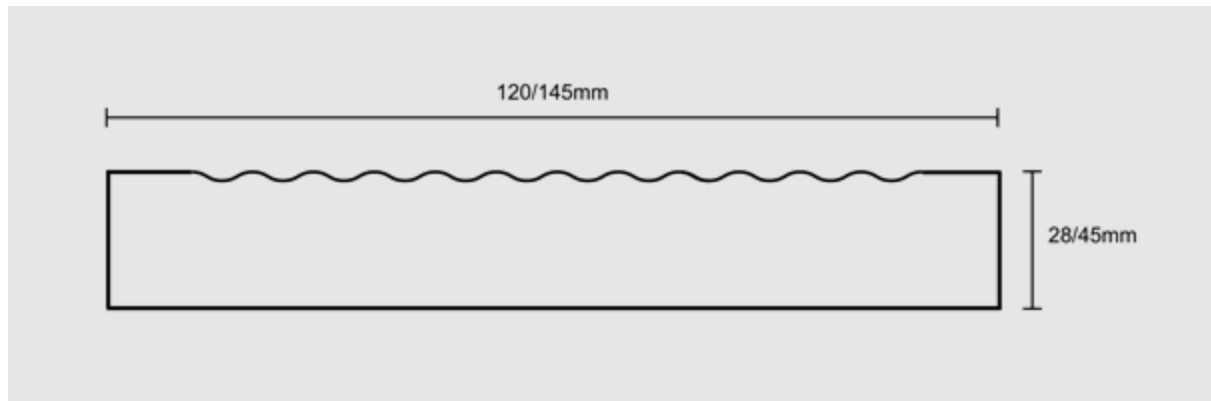



Corner Element Drawings

Corner Batten

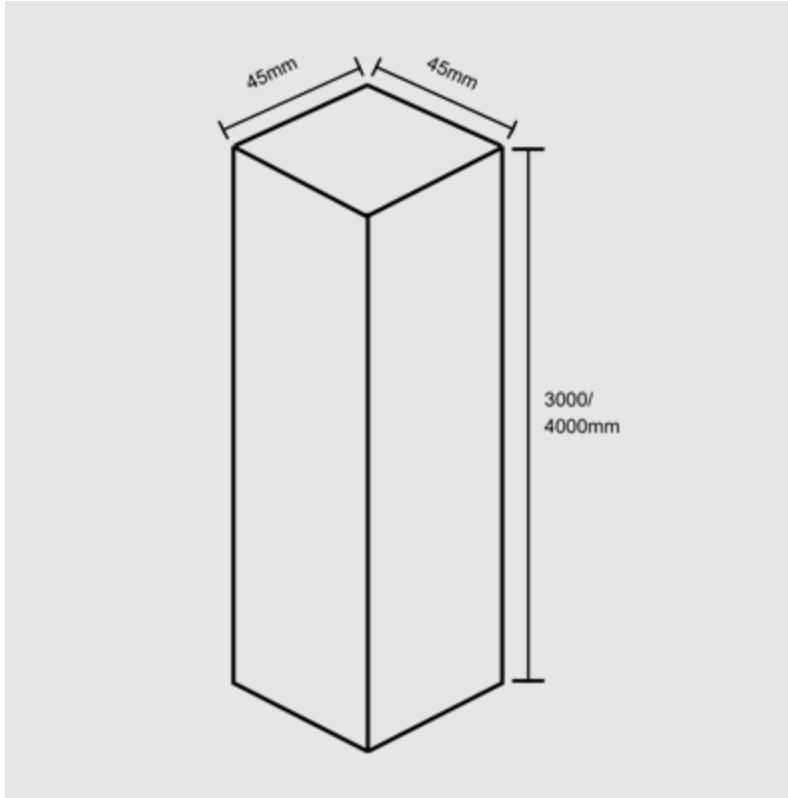

Corner

